

GN 327-A

Safety handwheels

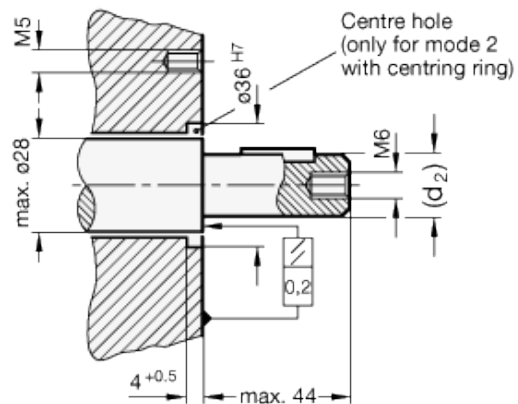

Specification of shaft and dimensions

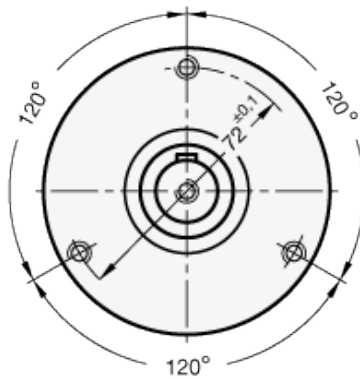

technical informations

Material

Aluminium, rim turned and polished.

Coupling attachments

- nitrided Steel.
- Bearing surface ground and / or PTFE-coated.
- Blackened bearing flange.

Assembly

- Identification no. 1: with bearing bush.
- Identification no. 2: with centring ring.

Features and applications

Safety handwheels GN 327-A feature the ultimate in health and safety at work standards because the handwheel, if disengaged, is mounted on a fixed component, the bearing flange. The wheel is fully disengaged from the rotating shaft. The bearing flange can also accept the bearing of the shaft via the bearing bushing (identification No. 1). This bearing bushing is a dry bearing (DU bushing). Normally, the shaft has a separate bearing and the bearing bushing serves to center the bearing flange.

Centering can also be effected by a centering ring (identification No. 2) if the appropriate bore hole has been made at the machine side. In this case there is no need for the bearing bushes and no bearing friction (heating) will occur.

Standard Elements	Main dimensions				Weight
	Description	d ₁	d _{2 H7}	b	
GN 327-160-K14-A-1	160	K14	18	66	1706
GN 327-160-K14-A-2	160	K14	18	66	1702
GN 327-160-K16-A-1	160	K16	18	66	1690
GN 327-160-K16-A-2	160	K16	18	66	1686
GN 327-160-K18-A-1	160	K18	18	66	1670
GN 327-160-K18-A-2	160	K18	18	66	1666
GN 327-160-K20-A-1	160	K20	18	66	1649
GN 327-160-K20-A-2	160	K20	18	66	1645
GN 327-200-K14-A-1	200	K14	20.5	68	2047
GN 327-200-K14-A-2	200	K14	20.5	68	2043
GN 327-200-K16-A-1	200	K16	20.5	68	2031
GN 327-200-K16-A-2	200	K16	20.5	68	2027
GN 327-200-K18-A-1	200	K18	20.5	68	2011
GN 327-200-K18-A-2	200	K18	20.5	68	2007
GN 327-200-K20-A-1	200	K20	20.5	68	1990
GN 327-200-K20-A-2	200	K20	20.5	68	1986



ELESA and GANTER models all rights reserved in accordance with the law. Always mention the source when reproducing our drawings.

STANDARD MACHINE ELEMENTS WORLDWIDE